

CSP-3164 CONSTRUCT NEW PORT COORDINATION CENTER FACILITY AT TURNING BASIN TERMINAL

Pre-Proposal Meeting
April 16, 2024
9:00 a.m.

PORT HOUSTON



PORT HOUSTON

AGENDA

1. Pre-Proposal Meeting House Rules
2. Introductions
3. Business Equity
4. Procurement Services
5. Selection Criteria
6. Project Scope
7. Questions



PRE-PROPOSAL MEETING HOUSE RULES

- Attendees will begin the meeting in listen-only mode.
- There will be a Q&A session at the end of today's presentation.
- If you have any questions during the presentation, you may submit your Questions through the Teams Chat feature and they will be addressed at the end of the presentation.
- This presentation recording will be posted on the BuySpeed homepage under "Pre-Bid/Proposal Conference Information."



PHA PERSONNEL

- Roger Hoh– Director, Project and Construction Management
- Harvey Ross – Project Manager
- Yvette Camel-Smith – Director, Procurement
- Tanika Chukwumerije – Manager Contracts, Procurement
- Alexis King– Contract Administrator, Procurement
- Dr. Sabeeta Bidasie-Singh - Director, Business Equity
- Brenda Ruiz – Business Equity Supplier Diversity Manager
- Eduardo Mejia – Compliance Analyst, Business Equity



Harris County Wage Rate Compliance & Requirements:

- Attendance at pre-bid/proposal meetings and preliminary meetings
- Review and approve weekly certified payroll records
- Monitor wage rate compliance
- Review claims of non-compliance from the field and recommend appropriate responses as required or permitted under the Wage Scale Act



PORT COMMISSION



Ric Campo
Chairman of the Port Commission



Dean E. Corgey
Commissioner



Clyde Fitzgerald
Commissioner



Stephen H. DonCarlos
Commissioner



Wendy Montoya Cloonan
Commissioner



Alan Robb
Commissioner



Thomas Jones, Jr.
Commissioner

BUSINESS EQUITY



PORT HOUSTON

BUSINESS EQUITY S/MWBE INITIATIVE

- Business Equity Division provides resources to small, minority- and woman-owned businesses (S/MWBE) seeking to participate in Port Houston procurements and contracts.
- Port Houston promotes business opportunities for all sectors of the community and recognizes the importance of vendor and supplier diversity in its contracts.
- Port Houston has established an organizational 35% Small Business participation goal and a 30% Minority- and Woman Business Enterprise (MWBE) aspirational goal.

35%

SBE participation
goal

30%

MWBE aspirational
goal



PORT HOUSTON

BUSINESS ENTERPRISE DEFINITIONS

Small Business Enterprise (SBE)

- Gross revenues or number of employees, averaged over the past three years does not exceed the size standards defined by SBA.
- The net worth of the owner must be less than \$1.32 million, excluding the owner's primary residence and assets of the business.

Minority Business Enterprise (MBE)

- At least 51% Owned by one or more Minority Individuals, or at least 51% of the equity is Owned by one or more Minority Individuals.
- Both the management and daily business operations are carried out and controlled by one or more of the Minority Individuals who own it.

Woman-Owned Business Enterprise (WBE)

- At least 51% Owned by one or more Women, or at least 51% of the equity is Owned by one or more Women
- Both the management and daily business operations are carried out and controlled by one or more of the Women who own it.



CERTIFYING PARTNERS

- City of Houston *
- Houston Minority Supplier Development Council
- METRO *
- National Minority Supplier Development Council & Affiliates
- Small Business Administration 8(a) *
- South Central Texas Regional Certification Agency – SCTRCA *
- Texas Comptroller of Public Accounts – HUB Certification
- Texas Department of Transportation – TxDOT *
- Women’s Business Enterprise Alliance
- Women’s Business Enterprise National Council & Affiliates – WBENC

* No fee to apply



PORT HOUSTON S/MWBE ENROLLMENT DIRECTORY

How do I identify Port Houston enrolled small, minority- and woman-owned businesses (S/MWBE)?

Search for businesses in 2 easy steps:

1. Visit <https://porthouston.smwbe.com> Under the section on the left labeled Small, Minority and Woman Owned Business Directory and Online Application select the blue button labeled, **"Find a S/MWBE Firm"**.

2. You will need to complete at least one of the fields in the popup window titled, Port Houston S/MWBE Enrollment Directory and Search.



OUR MAIN SITE

CONTACTS AND SUPPORT



SMALL, MINORITY AND WOMAN OWNED BUSINESS DIRECTORY AND ONLINE APPLICATION

Search for small, minority, and woman-owned businesses enrolled in Port Houston's Business Equity Programs, and/or apply to become an enrolled small, minority or woman-owned business.



Find a SMWBE Firm

OUTREACH & PROGRAM NOTICES

Business Networking Events

Detailed Description

RSVP For An Event

SYSTEM TRAINING

www.porthouston.smwbe.com



TIPS TO INCREASE S/MWBE PARTICIPATION

- Establish relationships with S/MWBEs in advance
- Use the Port of Houston Directory.
- Advertise opportunities
- Offer assistance and use the services and assistance, as appropriate, of such organizations as the Small Business Administration and the Minority Business Development Agency of the Department of Commerce.
- What subcontractor's have you done business in the past and do they qualify?



BUSINESS EQUITY CONTRACT REQUIREMENTS

- 30% Small Business Enterprise (SBE) participation, 10 points relative weight



PROCUREMENT



PORT HOUSTON

PROCUREMENT

- No Contact Period – No communication between interested vendors and Port Houston staff during the active period
 - Technical questions should be submitted via BuySpeed
 - Last day to submit questions: 7 days before due date (5/15/2024)
- Responses are due no later than 11 a.m. on 5/22/2024
- Proposals must be submitted electronically via email to: **procurementproposals@porthouston.com**
- Bid bond-5% Total Amount Bid
- Nondivisible Procurement
- Use forms in the package
- Anticipated award date: 6/25/2024



EVALUATION CRITERIA

Port Houston will select the provider of the services offering the best value to Port Houston. The criteria and relative weights that will be considered by Port Houston in evaluating each Response are as follows:

Evaluation Criteria	Relative Weight (%)
Price	40
Reputation, Quality, Safety, and Environmental Record	30
Benefit to Port Authority	15
Overall Compliance with Port Authority Policies	5
Small Business Participation	10



SCOPE OF WORK OVERVIEW



PORT HOUSTON

Project Scope

Overview

The project is the construction of a new Port Coordination Center facility located at the Turning Basin. The new facility consists of a two story, 30,000 square foot office building with an emergency operations center, training room and 3 apparatus bays. The building will be accessed by a new surface parking lot. The building is primarily tilt-wall concrete construction and will serve as a safe shelter for departments that remain on-site during extreme weather or similar events.

Building Departments

- | | |
|---|---|
| 1 | Emergency Management |
| 2 | Port Police Department |
| 3 | Port Fire Department |
| 4 | Security Department |
| 5 | Common Space including EOC & Training Room |
| 6 | Apparatus Bays for Port emergency vehicles. |

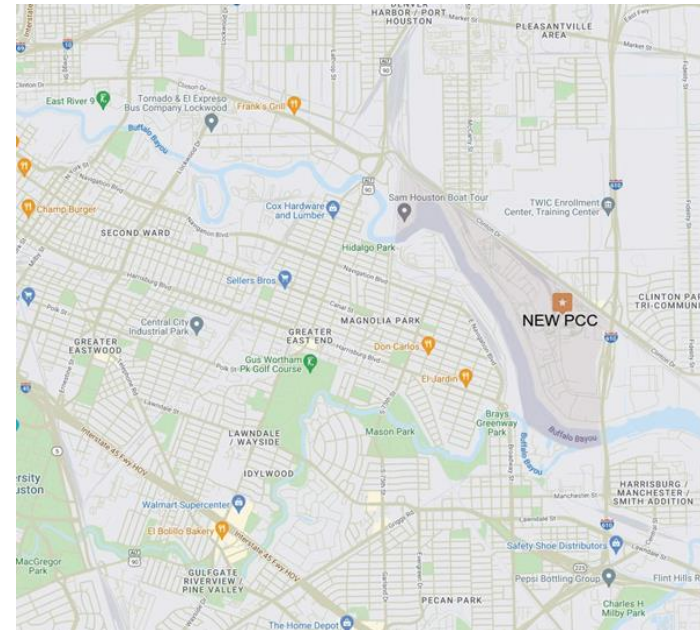







Site Vicinity

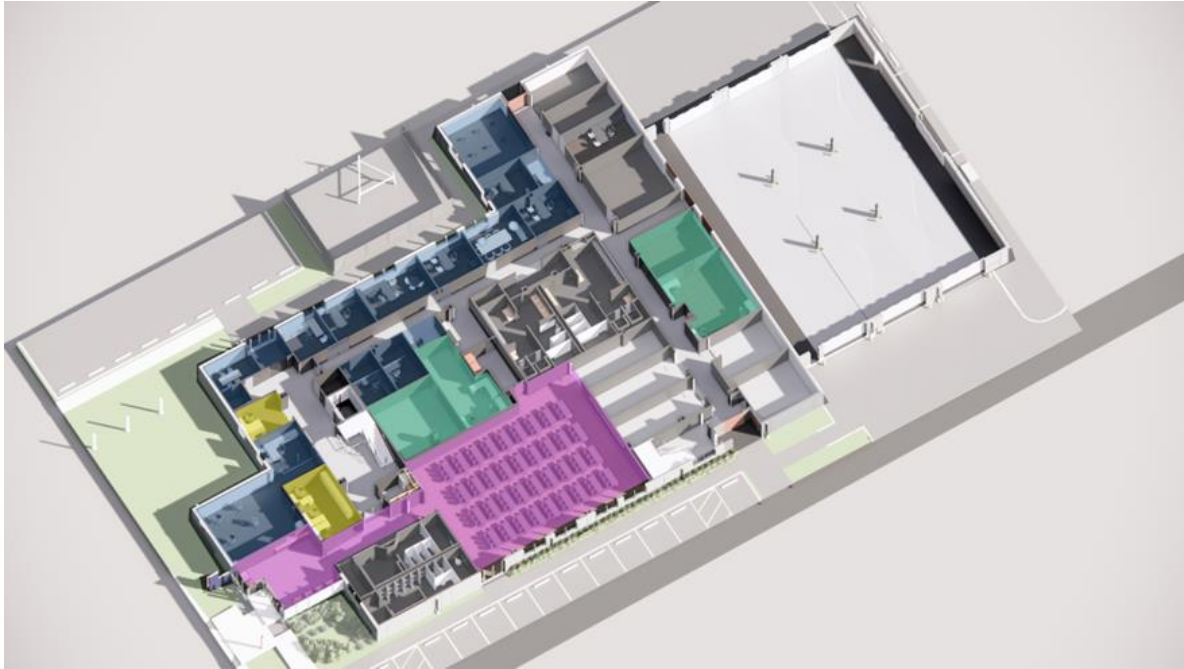

Project Scope

Site



-  Police Department
-  Emergency Management
-  Fire Department
-  Security
-  Common Spaces

Project Scope

Highlights

View of the entrance of the new PCC facing west. The walls are to be constructed of tilt-wall concrete.



View of the south side of the new PCC. In this view one can see the 3 apparatus bays.

SITE VISIT

- Date: Tuesday, April 16, 2024
- Time: 3:00 PM
- Address: Port Houston Executive Office Bldg. Lunchroom, 111 East Loop North, Houston, TX 77029
- PROPER PPE & ID REQUIRED, PREFERABLY TWIC



QUESTIONS?

Procurement Services

Email: procurement@porthouston.com

Phone: (713) 670- 2464

New BuySpeed URL:

<https://buyspeed.porthouston.com>



PORT HOUSTON